

---CLINICAL WORKSPACE---

- [3] 6'x6'x67"H POWERED STATION
- [4] 6'x5'-6"x67"H POWERED STATION W/
- [1] BOX BOX FILE PEDESTAL /EACH
- [1] OVERHEAD W/ FLIPPER DOOR /EACH

---CASE MANAGEMENT 2---

- [2] 8'x5'x39"/67"H POWERED STATION W/
- [1] BOX BOX FILE PEDESTAL /EACH
- [1] 30"W OVERHEAD W/ FLIPPER DOOR /EACH

---OFFICE SUITES #1,2,3 & INTAKE---

- [3] 6'x6' L-SHAPE DESK
- [1] 6'x5' L-SHAPE DESK W/
- [1] BOX BOX FILE PEDESTAL /EACH

---OFFICE SUITE #4 | NEW---

- [1] 6'x6' L-SHAPE DESK W/
- [1] BOX BOX FILE PEDESTAL /EACH

---BED-2 & OPERATIONS---

- [2] 8'x6'x67"H POWERED STATION W/
- [1] BOX BOX FILE PEDESTAL /EACH
- [1] 36"W OVERHEAD W/ FLIPPER DOOR /EACH

- [1] 5'x5'-6" L-SHAPE DESK W/
- [1] BOX BOX FILE PEDESTAL /EACH

---SEATING---

- [17] TASK CHAIRS
- [16] GUEST CHAIRS

2D OVERALL LAYOUT

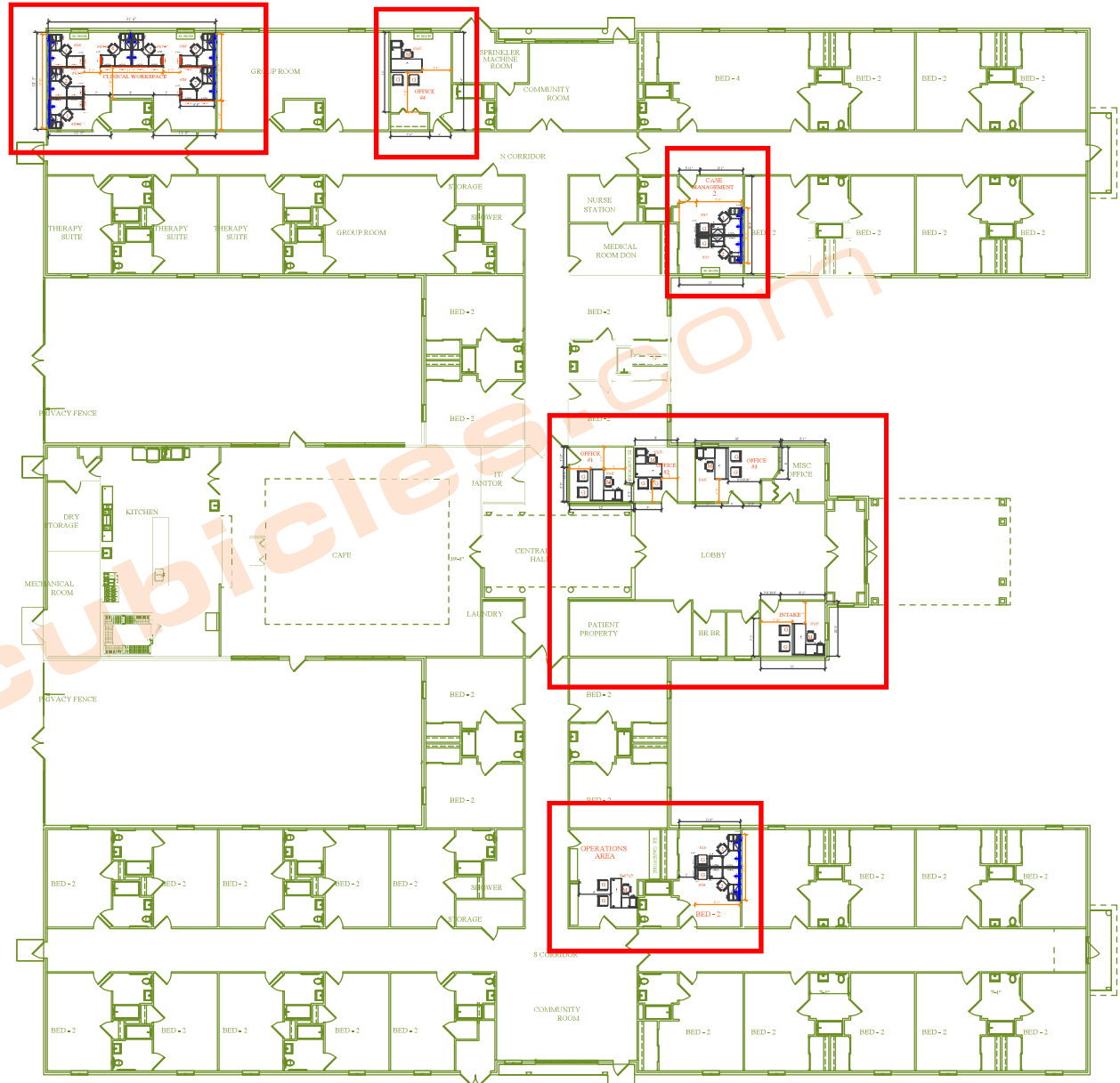

NON-POWERED COMPONENTS
NEW POWERED ELEMENTS